

Attachment B1

Selected Drawings

357 Glebe Point Road, Glebe

Development Summary

Site Area: 5,556 m²
 Proposed FSR: 1.36 :1
 Max GFA: 8,334 m²
 Bidura House GFA: 466 m²
 Proposed GFA: 7,546 m²

	Building					Sub	*NSA m ²	GFA m ²
	1B	2B	3B	1B-T	2B-T			

4	3					0	218	218
1	4	2	4	3	7	14	961	1,175
1	5	2				14	1,260	1,461
1	7	3				8	1,210	1,337
1	4	4				11	1,011	1,132
	3	3	1			9	867	966
						6	555	614
						1	165	177

LEVELS	Basement 2 & Basement 3
Ground	Basement 1 / Lower Ground
Level 1	
Level 2	
Level 3	
Level 4	
Level 5	

Bidura House

466

8	26	15	4	3	7	63	6,247	7,546
13%	41%	24%	6%	5%	11%	100%		
12	29	22				63		
19%	46%	35%				100%		

(all 1B+1B-T) (all 2B+2B-T) (all 3B+3B-T)

*Basement 2 areas inclusive of mezzanine level

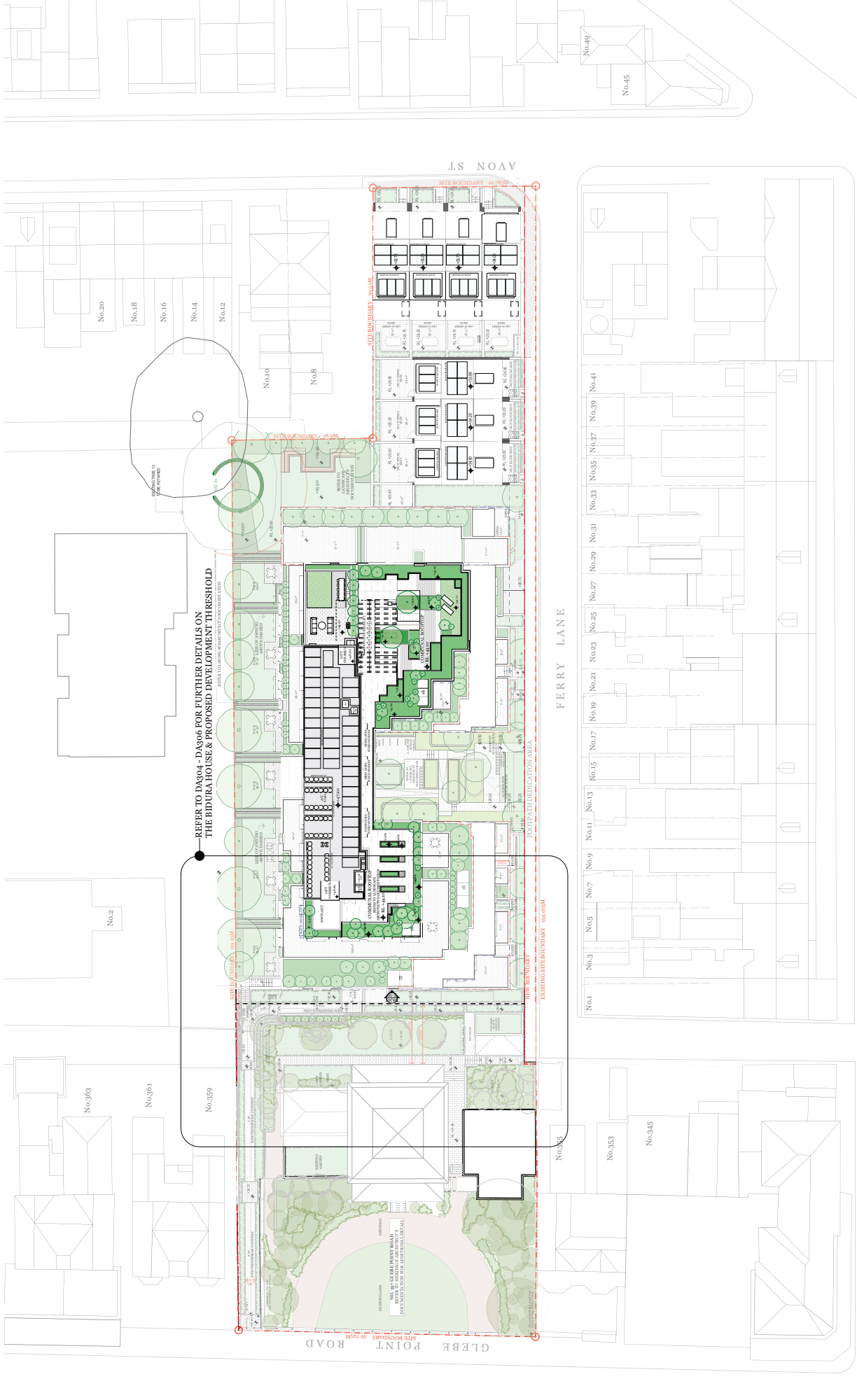

REFER TO DA304 - DA306 FOR FURTHER DETAILS ON THE BIDURA HOUSE & PROPOSED DEVELOPMENT THRESHOLD

Rev.	Date	By	Old	Description
1	24/03/2024	MM	NR	Issue for DA



DKO

DKO Architecture (NSW) Pty Ltd
 1/100-1/102 Sydney Road
 Sydney NSW 2000
 Australia
 www.dko.com.au
 NSW Registered Architects
 David Bunker 08/24

ARCHER OFFICE

Project Name
 Project Address
 Client
 Vision Land

Project Number
 Drawing Name
 Date Commenced
 Revision
 Drawing Number **DA105**
 C

